

HyPort Series

Medical supply unit

Care for health with optimal workflow





Intensive care unit (ICU) plays a pivotal role in treating diseases with the development of medical science. As a new standard configuration of ICU, ceiling supply units are not only equipped with simple power and air supply, but also endowed with more responsibilities and missions, so as to create a safer, high-efficient and healthier ICU environment.

Efficiency

A highly integrated bedside device management system helps caregivers organize medical devices to various clinical needs. It makes efficient use of bedside space with a series of easy-to-use designs, enabling a more efficient workflow for medical staff.



Folding shelf

Portable ventilators can be safely placed on the shelf, and the shelf can be folded up to make more space for integrated ventilators.



Bag-valve-mask management

It can rapidly respond to the use of breathing balloon, enabling better organized rescue and saving the precious time for first aid.



Partition management

The device can be managed in partitions, and the power and air supply can be rapidly and conveniently plugged in and out.

The pump separation layout allows medical staff to easily identify infusion pumps and feeding pumps.

Safety

Safety is the first priority to the medical environment. With the EU standards ISO 11197-2019 Medical Ceiling Supply Unit as the basis of design, HyPort is manufactured according to higher standards.



Brake system

Besides the standard friction brake, pneumatic or electromagnetic can be an option for additional safety.



Oxygen concentration monitoring

24-hour continuous monitoring of oxygen concentration with built-in alarm system



Infection control

- Screwless design ensures no snags or cuts
- Antimicrobial powder coating surface treatment

Cable management

In the critical care area, cables, leads, hoses, and other critical accessories need to be organized and easily accessible. Accessories that aren't stored properly have shorter service lives, and damaged and disorganized accessories can impact the quality and speed of patient care.



Electrical cables hidden inside the column cavity*



Built-in cable management with flexible position*



Leadwire management

- A multifunctional management system of leadwire manager is adopted
- The switching design is applicable to the management of lead wires of different sizes and avoids the risk due to traction of wires
- The design of hooks allows the accommodation of excess cables



Pump cable clamps

The infusion pump extension arm's clamping system efficiently conceals power cables behind the pump. This not only prevents medical safety risks from plugging errors but also allows for quick access to the power supply when transferring the pump.



Bedside device cable manager

- Effective management of power cables of various bedside devices.
- Prevention of safety risks such as plugging errors

* Available for Σ distribution

Variety

HyPort P30 is another solution for critical care areas, allowing hospitals to have more choices according to economic efficiency, room size and critical severity.



Optional with quiet electro-magnetic brakes



Considerate lighting option



Integratable HyLED 200 treatment light with 70,000 lux



Double arms ICU pendant



Single arm ICU pendant



Rigid pendant for NICU, recovery room



Dual pendants with patient lifting system

Variety

As medical treatment and nursing have advanced, ICUs have evolved into general ICUs and special ICUs, each requiring different layouts. The HyPort R80 is designed to be suitable for ICU layouts across various departments, making it adaptable to changing needs and treatments for every disease.



ICU
ICU open room

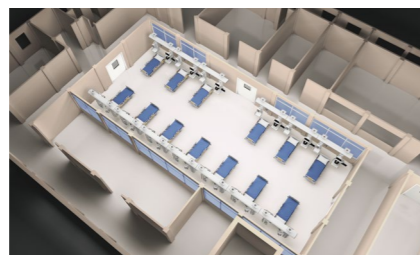

ICU
(single room)



Normal light



Swivel arm solution

ICU
(single room)



Circadian light



Swivel arm solution

ICU
(double room)



Normal light



Circadian light

ICU
(double room)



Normal light
single swivel arm solution



Double swivel arm solution

ICU
(double room)



Normal light



Solution for combined arrangement of
three columns for two beds

Recovery

Studies have shown that over half of ICUs are enclosed spaces, and a poorly lit environment can negatively impact patient rehabilitation and the work and well-being of medical staff. With its integrated lighting solutions, the HyPort R80 can effectively optimize the ICU environment and provide a healthier lighting system for all involved.

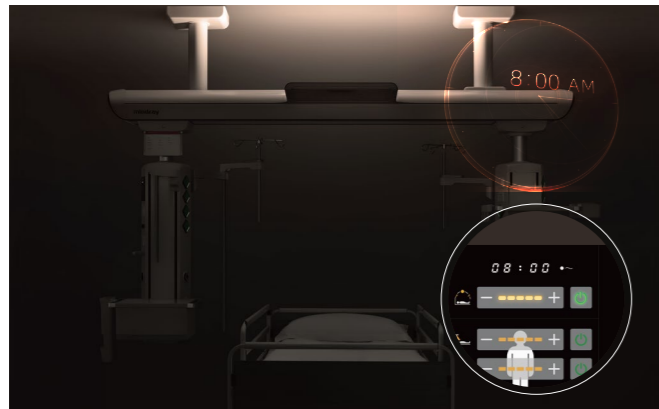

Circadian light

Full of energy in the morning and plenty of rest in the evening

- LED design with spectra mimicking 24-hour sunlight changes and infinitely approaching sunlight spectra
- Simple operation and automatic adjustment
- Multiple levels of illuminance

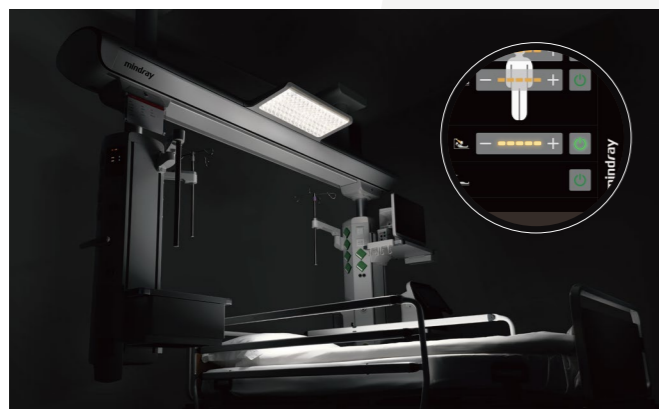

Reading light

Anti-blue-ray design that enables easier reading

Effectively avoid invalid glare and guarantee the reading needs of rehabilitating patients.

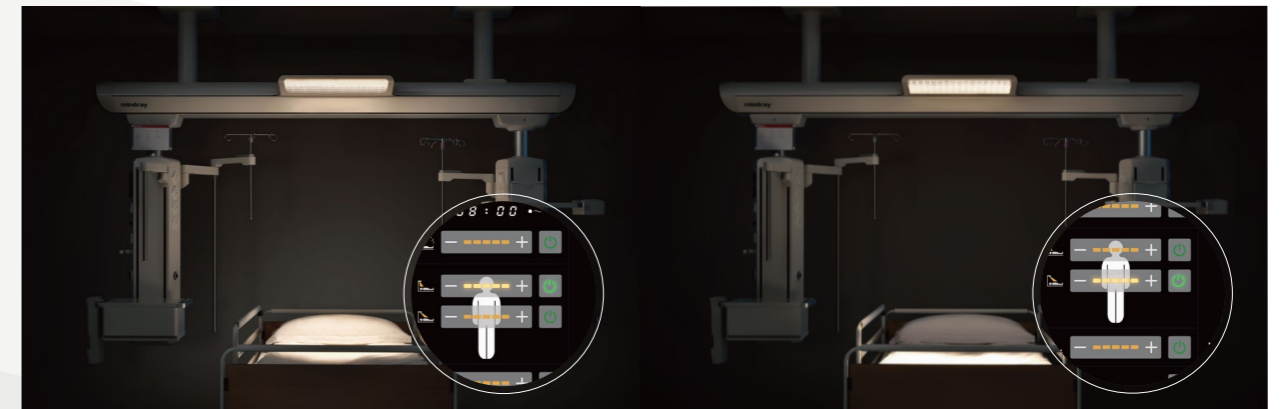

Examination light

Convenient for operation by doctors, reducing invalid glare

- Brim solution designed with 96 LED arrays
- The principle of internal reflection and the scaled design of the lens of auxiliary light for surgery can decrease invalid glare
- The examination light is designed with the highest illuminance of up to 10,000 Lux, which can be used for shadow-free illumination as well, with 5 levels of adjustable illuminance

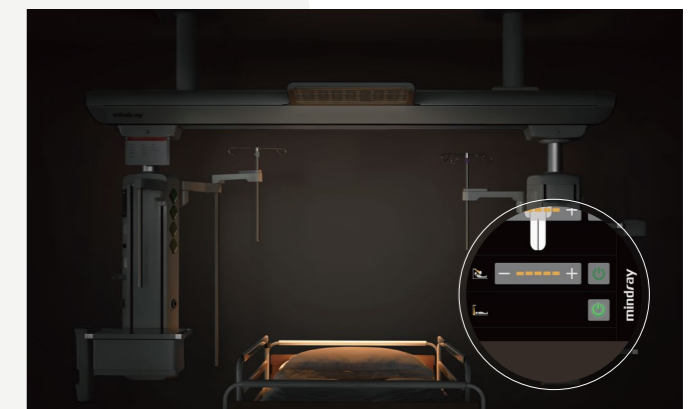
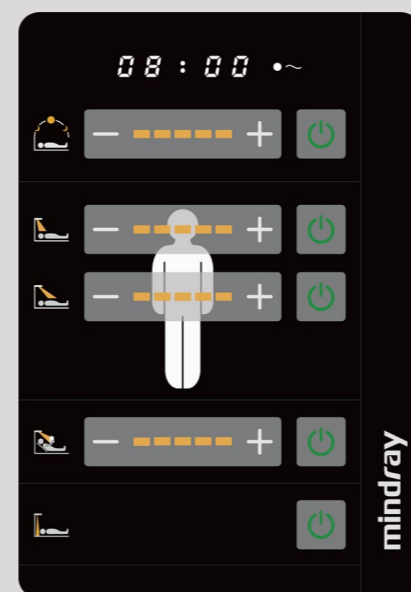

Navigation light

Elliptical light design

Convenient for night observation and operation by healthcare workers.